

FIXED FRAME

FOR ALL FIXED/STATIC BEDFRAME MODELS



Easy set up instructions for your new Handmade bed

THIS INSTRUCTION PACK IS UNIVERSAL ACROSS THE RANGE
IMAGE USED MAYBE DIFFERENT FROM THE ONE IN PACK

ASSEMBLY
INSTRUCTIONS



REF CODE:
FHL - IN-UPH-STA

UPDATED: 18-SEPT-23



Information, diagrams and steps illustrated in this Assembly Guide
are correct at the time of publication.

Introduction and components



1. Unpack in the room the bed is intended to be used, remove all packaging and dispose of carefully, keeping polythene out of the reach of children.

SLATTED FRAME CONTENTS:

- 1 x Head board
- 2 x Side Rails
- 1 x Foot board
- 1 x Centre Support Rail
- 1 x Slatted Frame
- 2 x Connecting Bars
- 4 x M6 Flange Nuts (Frame Assembly)
- 4 x M6 40mm Fixing Bolts (Frame Assembly)
- 3 x M6 70mm Fixing Bolts (Frame Assembly)
- 3 x M6 Fixing Nuts (Frame Assembly)
- 8 x 20mm Fixing Washers (Frame Assembly)
- 2 x 55mm Screws (Frame Assembly)

CHECK LIST - SLATTED FRAME ASSEMBLY

Please check the pack contents before attempting to assemble this product.
If any components are missing, please contact the retailer from whom you bought this product.

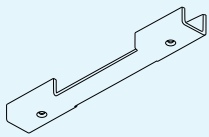

CONNECTING-BAR
= x2

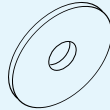

FIXING-WASHER
M6X20mm = x8

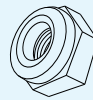

FIXING-NUT
M6 = x3

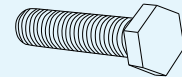

FIXING-BOLT-
M6X70mm = x3



FIXING-NUT FLANGE
M6-HEX = x4

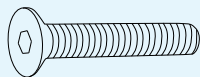

FIXING-BOLT-
M6X40mm = x4

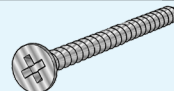

WOOD SCREW
55mm = x2

**This product is HEAVY, it should be assembled as near to the point of use.
TAKE CARE WHEN LIFTING to avoid personal injury and (or) damage to the product.**

This product takes approximately 60 MINUTES to assemble with 2 PEOPLE.

**The fittings pack contains SMALL ITEMS which should be KEPT AWAY FROM YOUNG CHILDREN.
Read this instruction leaflet in full before commencing assembly.**



TOOLS REQUIRED

The following tools are required for this assembly
1 x Socket Set - 13mm Spanner
1 x Cross Head Screwdriver (also known as a Phillips)



CAUTION WITH ASSEMBLY

Some stages of this Bed Assembly will require two people to hold and lift components that maybe heavy.



Please Note: this step will require two people and requires lifting.

For beds with LOW foot board, follow steps below.

2.1 Fitting the side panels to the head board/foot board.

- Stand the head board upright in its required location.
- Attach the first side by slotting the brackets with the tongue onto the four allen bolt heads.
- Push down the side and the bracket will locate behind the bolt head. Tighten each bolt with an allen key.
- Repeat on the other side of the head board.
- Follow the same steps and attach the foot board.

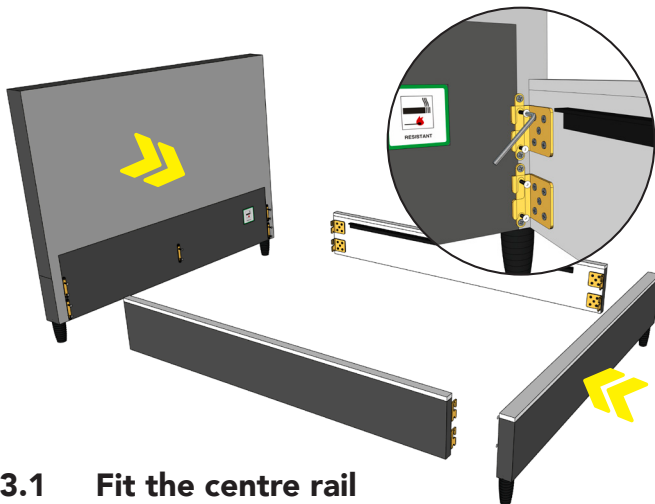

3.1 Fit the centre rail

- Put the centre support rail into place by twisting it into position.
- Tighten all bolts using the allen key.

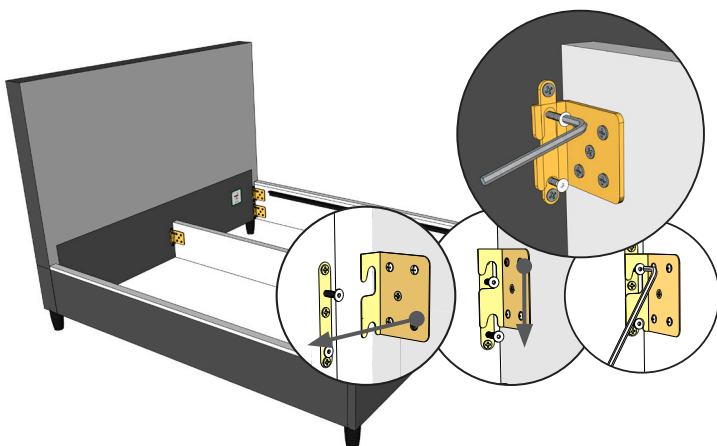

For beds with HIGH foot board, follow steps below.

2.2 Fitting the side panels to the head board/foot board.

- Stand the head board upright in its required location.
- Attach the first side by slotting the brackets with the tongue onto the four allen bolt heads.
- Push down the side and the bracket will locate behind the bolt head. Tighten each bolt with an allen key.
- Repeat on the other side of the head board.
- Follow the same steps and attach the foot board.

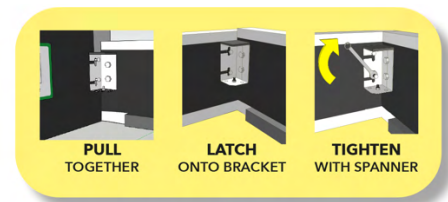

3.2 Fit the centre rail

- Put the centre support rail into place by twisting it into position.
- Tighten all bolts using a spanner.



FOR SLATTED SLATTED FRAME OPTION

*We recommend flipping the slatted frames for easier access to bolt holes.

4. Your slatted frame will arrive in two sections and are **required to be connected together** by following the next steps.

5. On each of the points - use **one** fixing bolt **two washers** and **one fixing nut** to secure the frame together.

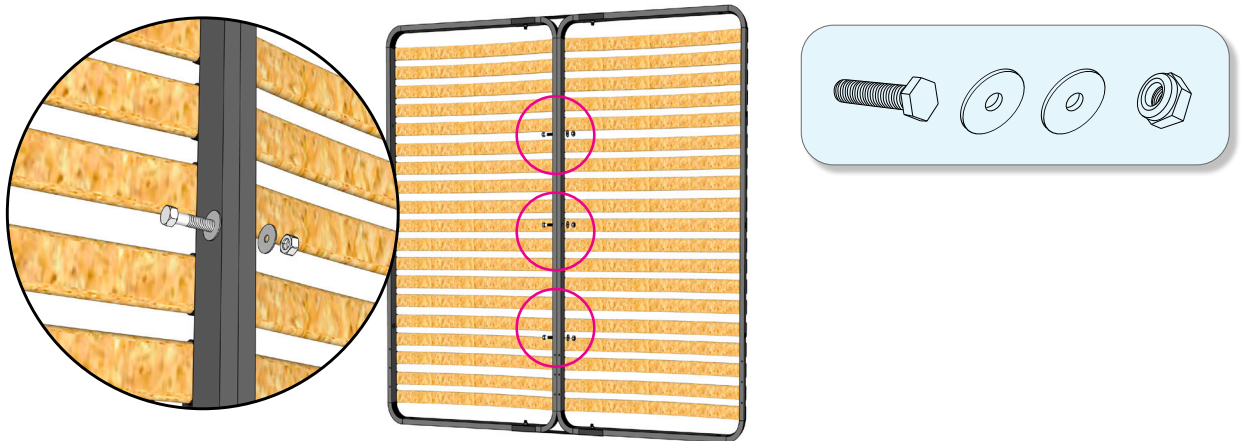

6. Place the two brace bars onto the slatted frame at each end. These are fixed by the allen key bolts supplied in the bag.

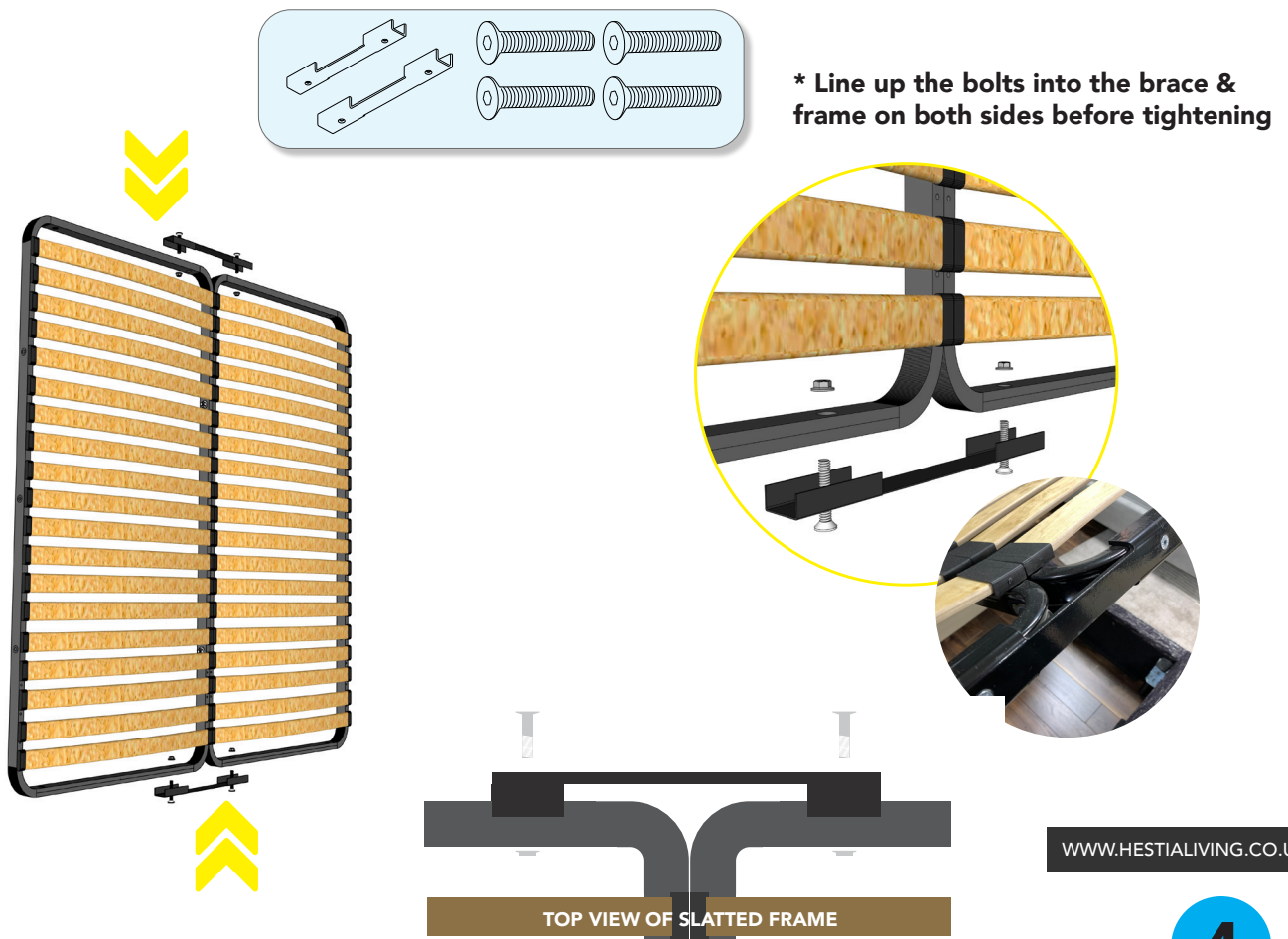

7. Fitting the slatted base on your bedframe.

- Once you have completed the previous steps, lower the slatted frame that was stood to one side into the bedframe.
- This step will require careful positioning inside the bedframe and requires two people.



Please Note: this step will require two people and requires lifting.

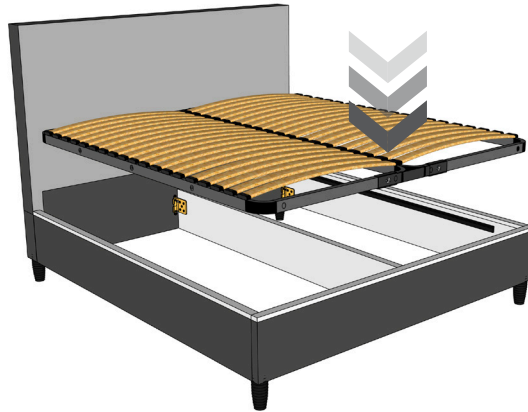

8. Lower the slatted frame into the bedframe making sure you move the slatted frame so that a 20mm gap is made at the head and foot end (frame is centred). Then place the 2x55mm screws (with 1x washer on each) and fix in place either side of the frame.

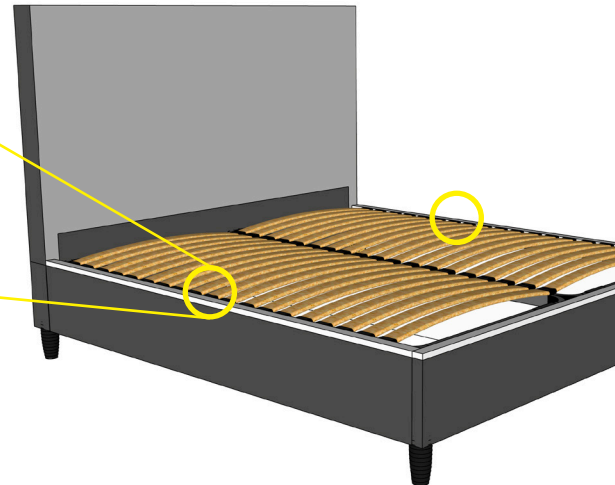
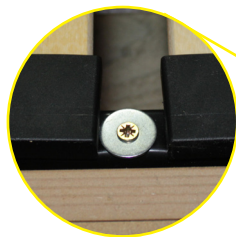

9. Simply place your mattress onto the slatted frame when complete.



MADE WITH OVER
50
YEARS OF
EXPERIENCE & EXPERTISE
ESTABLISHED 1968



MATTRESS CARE GUIDE



- ✓ **Turn your mattress** over completely every 2 weeks for the first 3 months, both side to side and head to toe, then every other month thereafter. With no-turn mattresses, rotate head to toe.
- ✓ **Air your bed thoroughly** once a month by stripping the bedclothes and leaving for a few hours.
- ✓ **Use a mattress protector** to prolong the life of your bed. As the mattress materials need to breathe, we would suggest you avoid using plastic-based sheeting, as this will lead to damage caused by condensation.

Mattress maintenance plays an important role in extending the lifespan of your mattress, as well as ensuring you get optimum comfort while sleeping.

Once you and your new mattress have got to know each other, we recommend some maintenance tips to ensure your mattress lasts for as long as possible. These include rotating and/or turning over your mattress, cleaning your mattress, and airing it out.

- ✗ Don't sit on the edge of your mattress. They are designed to have weight spread over the whole area.
- ✗ Don't bend or roll your mattress, this can cause damage to the spring unit and tear the material.
- ✗ Don't walk or jump on your bed and please don't let children use it as a trampoline!



Hestia[®]
LIVING

Natural Tufted Range of Mattress

Do not worry if hollows appear in the sleeping areas of your mattress. This is quite normal and is not a fault. Due to the top layers consisting of wool/silk and cotton, it is important that the mattress is kneaded to bring it back to its original condition each month. This will reduce the amount of natural settlement that will happen.

WWW.HESTIALIVING.CO.UK





Your Guarantee

We are delighted that you have bought one of Furmanac Hestia Living British, quality handmade beds.



We're so confident in the quality of our workmanship that every upholstered bed comes with our 7 Year Frame and Frame Construction Guarantee. This covers the timber frame and frame construction on models. In addition, all motion mechanisms, electric motors and power packs come with a 5-year warranty.

Our skilled craftsmen have created furniture of outstanding quality for over 50 years and we hope you enjoy its comfort and style for many years to come.



For full details on this Guarantee* please visit: www.hestialiving.co.uk